

## Aquila 50 Yacht Power Catamaran Specifications

Length overall	15.9 M / 52' 2"
Beam overall	7.76 M / 25' 6"
Cabins-standard	3/3 + utility room
Cabins-optional	4/4 + cpt. quarters

## Tankage

Fuel tank	1,600 L / 422 GAL
-----------	-------------------

## Propulsion

Standard	2x D6 480 HP VOLVO PENTA
----------	--------------------------

Estimated Performance	WOT @ 22knots / Cruise Speed @ 18-19 knots (estimated speeds are non-contractual)
-----------------------	--

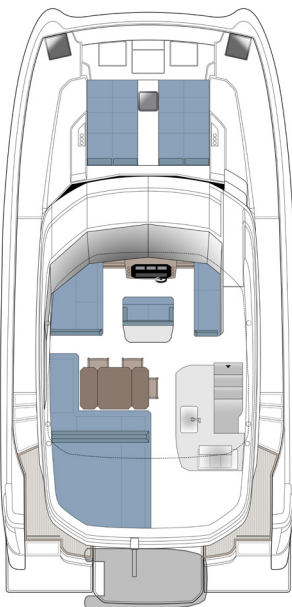

STANDARD FLYBRIDGE

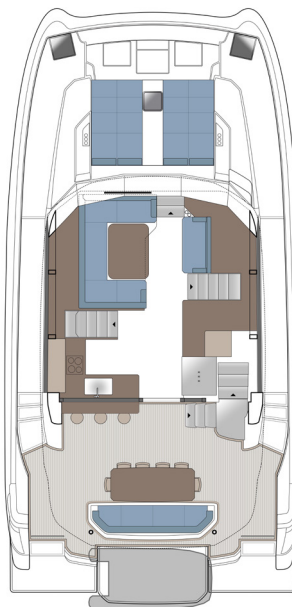

STANDARD MAIN DECK

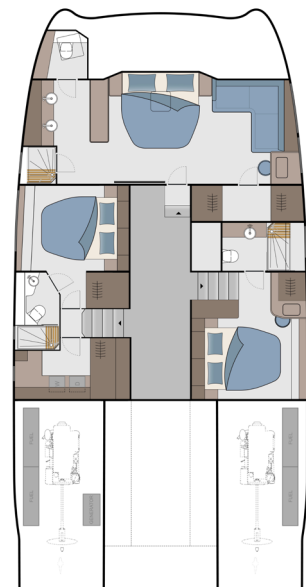

STANDARD 3-CABIN,  
+UTILITY ROOM

All specifications and options are subject to change by Sino Eagle Yachts at their sole discretion. Performance is purely indicative and not a contractual commitment. Performance is subject to many variances outside the control of Sino Eagle Yachts. Specifications and graphics in this brochure are non-binding and customer must enter into contractual agreement with the Dealer or Agent of Record.