

54



54 YACHT POWER CATAMARAN

54

YACHT POWER CATAMARAN

The Aquila 54 Yacht Power Catamaran represents the reliable features and construction methods of the hundreds of Aquila yachts and boats cruising the waters of the world. This model enhances on-board luxuries with full size refrigeration and layouts that include 3, 4, and 5 cabin options as well as skipper's quarters and "galley-down" layouts.

Customization options are available to meet an assortment of boating lifestyles.







Integrated entertaining bar connecting social areas





PANORAMIC LUXURY





Wet bar with Kenyon grill and Corian work surface

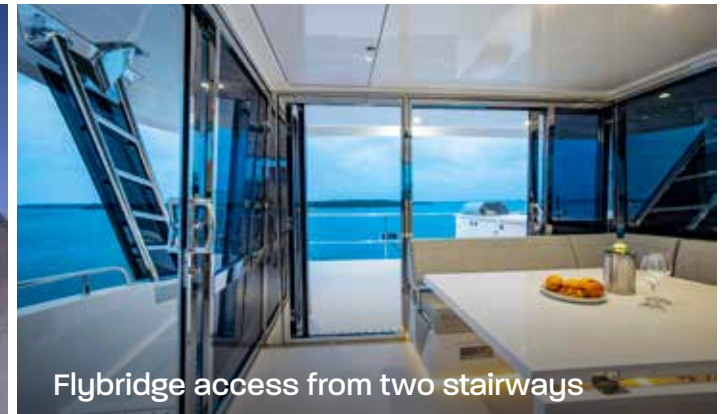

Flybridge access from two stairways

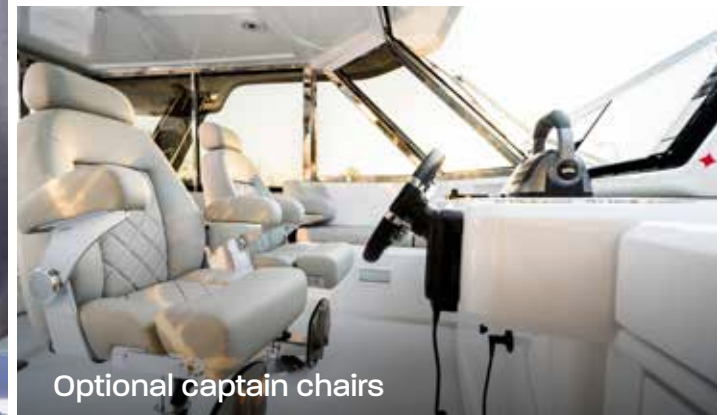

Optional captain chairs

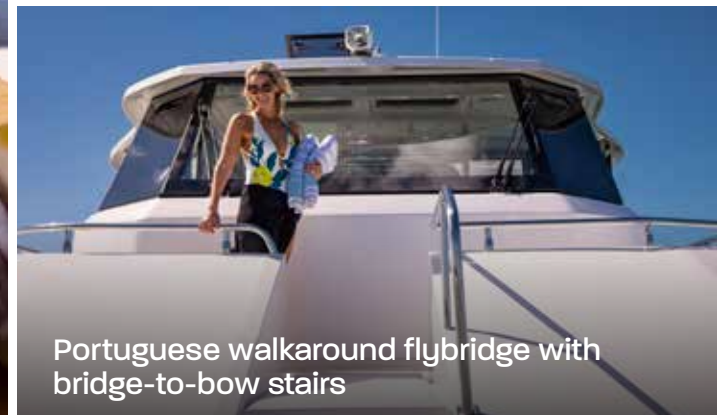

Portuguese walkaround flybridge with bridge-to-bow stairs



Optional fully-enclosed SkyLounge Flybridge

The image shows the interior of a modern catamaran. In the foreground, there is a white leather sofa with a blue textured blanket draped over it. The background features a large window with light-colored curtains, providing a view of the outside. The interior has light wood paneling and a polished wooden floor. A small table is visible on the right side of the sofa.

SUPERIOR QUALITY

Excellent all around visibility with comfortable salon seating





Salon with convertible dining table



Aft cockpit entertainment area including bar and table

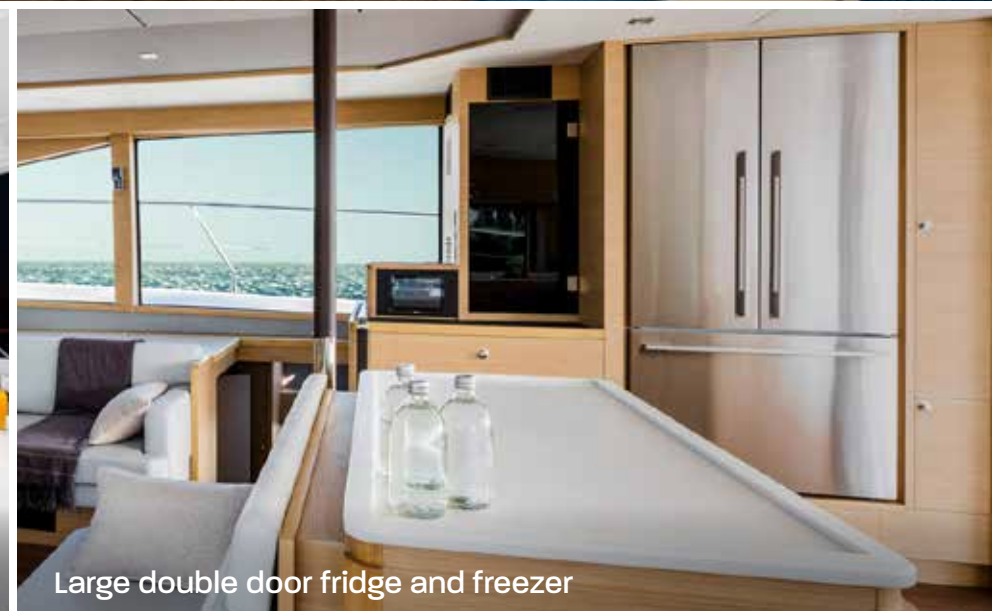

Large double door fridge and freezer



Fully equipped galley with optional dishwasher and wine cooler



The image shows the interior of a modern catamaran cabin. A large bed with a grey textured blanket and white pillows is in the foreground. The cabin features light-colored wood paneling and built-in furniture. A wooden bench or headboard area has a mirror and a small framed photo. Large windows with beige curtains look out onto a blue sea. A black oval hatch is visible on the left side of the cabin.

COMFORTABLE LIVING





Master head with electric push button control

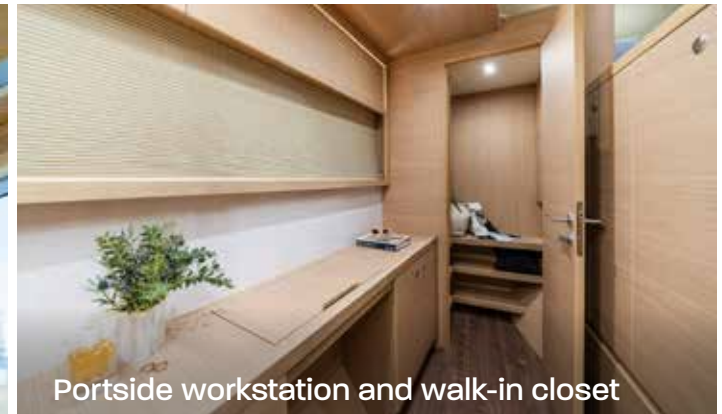

Portside workstation and walk-in closet

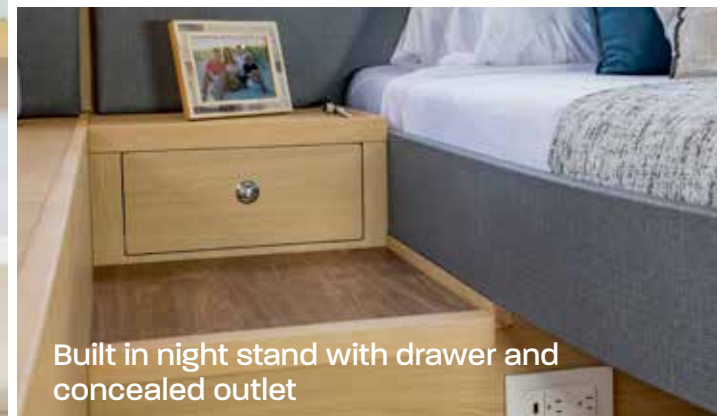

Built in night stand with drawer and concealed outlet



Touch lighting control



Full-beam forward master cabin



VIP portside cabin with generous natural light



Separate shower stall with seat



VIP head with fresh water flush toilet



VIP starboardside cabin



**QUALITY
INNOVATION
PERFORMANCE**





Secure tender storage



Optional Aquila 14' catamaran RIB



Concealed tender crane system



Intelligent C-Zone control



Bulbous Bows



Bridge-to-bow stairs





SPECIFICATIONS

Length overall w/ swim & protection platform	16.5 M / 54'2"
Beam overall	7.68 M / 25'2"
Height above waterline w/ hard top, electronics	7.43M / 24' 4"
Draft including propeller (depends on load)	1.37 M / 4'6"
Fuel tank	2200 L / 581 GAL
Water tank	1000 L / 238 GAL
Holding tank	340 L / 90 GAL
CE certification	Cat. A (Ocean): 12 PAX

Propulsion

2 X D6-380HP VOLVO PENTA (STANDARD)

2 X D8-450HP VOLVO PENTA (OPTIONAL)

2 X 550HP CUMMINS QSB 6.7 (OPTIONAL)

*The specification measurements are approximate and subject to variance.
Actual color samples may vary slightly from digital representation.*



54

YACHT POWER CATAMARAN

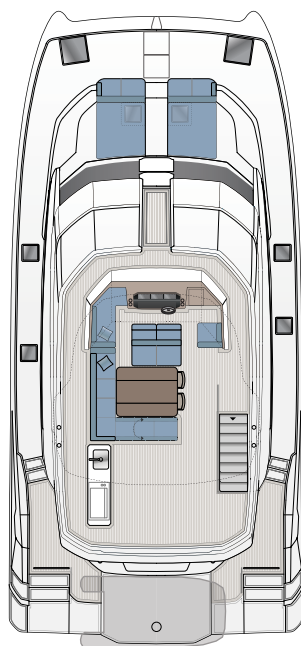

STANDARD
FLYBRIDGE

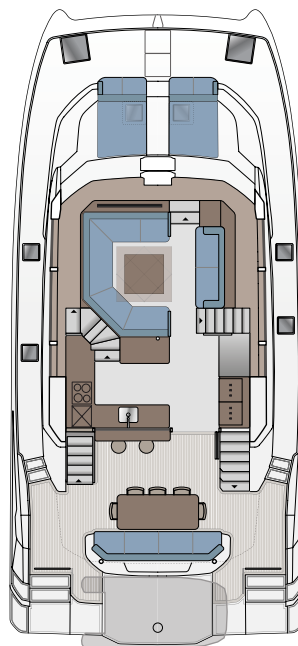

STANDARD
MAIN DECK

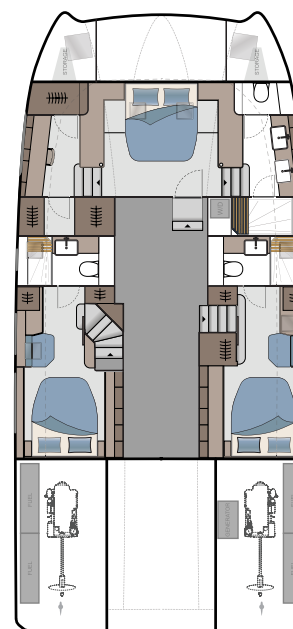

STANDARD
3 CABIN

AVAILABLE DECK LAYOUT OPTIONS

FLYBRIDGE OPTION

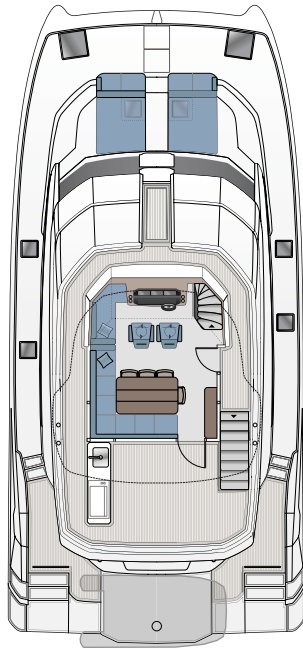

SKYLounge
FLYBRIDGE

MAINDECK OPTIONS

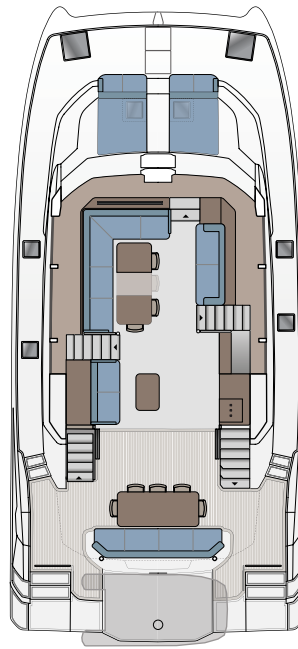

MAIN DECK
GALLEY DOWN

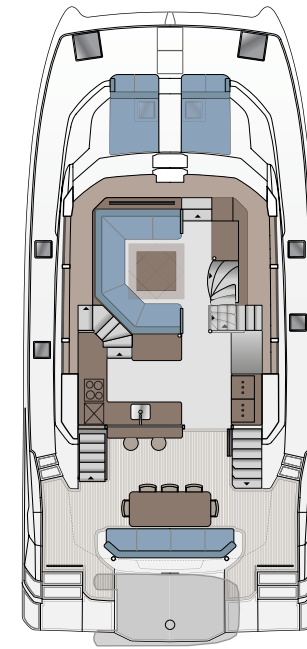

MAIN DECK
GALLEY UP
(SKYLounge FLYBRIDGE)

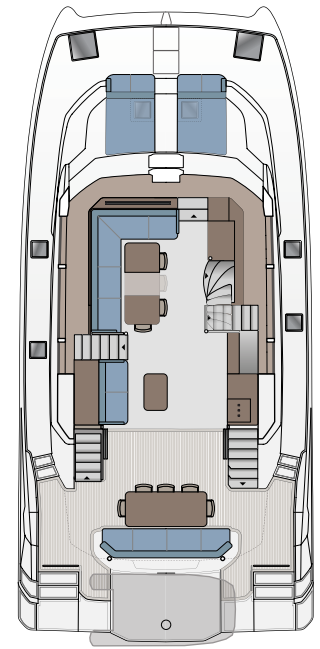

MAIN DECK
GALLEY DOWN
(SKYLounge FLYBRIDGE)

CABIN OPTIONS

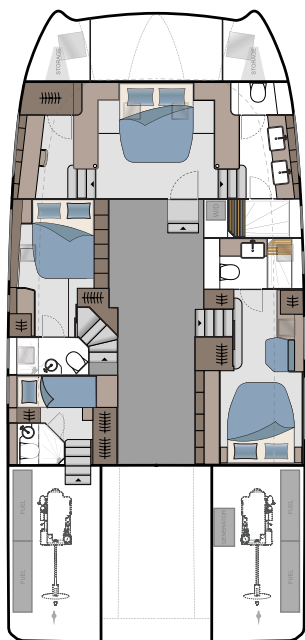

**4 CABIN
GALLEY UP**

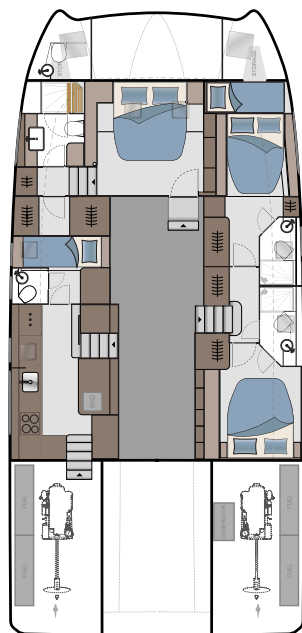

**4 CABIN
GALLEY DOWN**

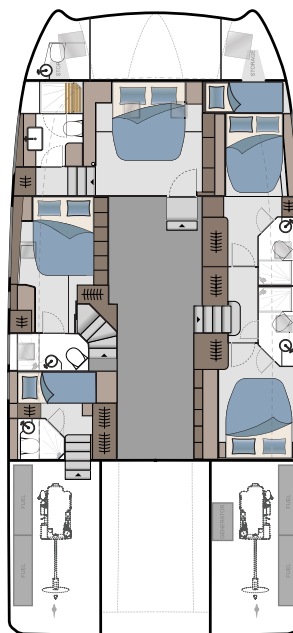

**5 CABIN
GALLEY UP**





With over 40 years of manufacturing experience and the collaboration of multiple award-winning firms and designers, Aquila Power Catamarans is the recognized leader for innovation, quality and performance in this growing category of pleasure boats.





Copyright © 2019 Aquila Boats. All rights reserved. Photography by Nicolas Claris and Billy Black.